

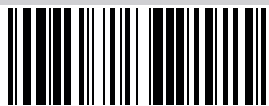

EN

## Technical Data Sheet, Installation and User Guide

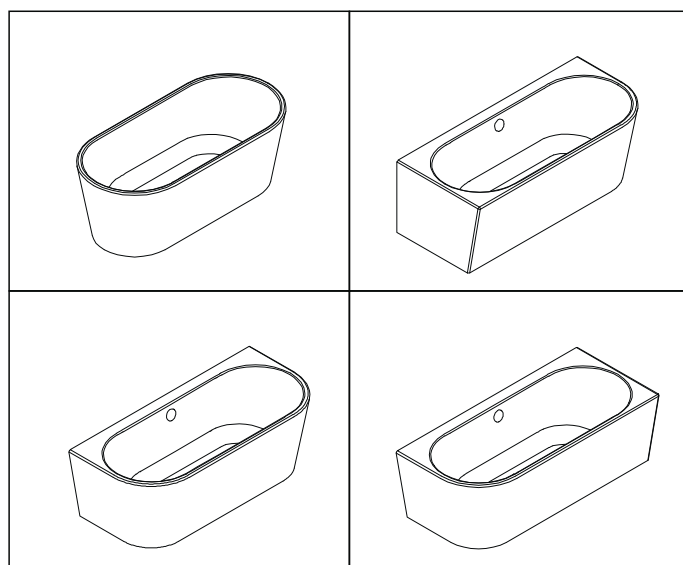

5905698

20230301-01

pianura

Dear customers,

Thank you for preferring our product. We strongly advise you to read the present manual thoroughly before procuring installation of your product and maintain as a reference guide for any future references.

1.1. The installation should be done according to the installation manual. We urge you to carefully read this guide in full before having our product installed and keep it for future reference

1.2. For the installation of the product, you should use the installation pack supplied with the product or the recommended auxiliary materials. Use our special screws and dowels for brick or concrete walls. Drill hole on the brick or concrete walls in the same diameter as dowel. Pile the plastic dowel in the same level as the wall and screw it by using special screw. For other wall types, installation parts can be supplied from specialized stores.

1.3. Materials that expand while freezing such as cement, plaster, etc. should not be used in installation.

1.4. Accept the purchased product by removing it from its carton at our sales point and/or at the delivery to address and checking its parts one by one. If any missing materials or any breakage or damage is detected, inform the nearest Authorized Seller or the Authorized Service. In such cases, please protect the product in its original packaging.

1.5. Have the User Manual of the product which you have received without any missing parts or any damages APPROVED by the Authorized Seller.

1.6. Please call the Authorized Service after completing the preparations for the required infrastructure.

1.7. In the event you need service for installation, maintenance and repairs;

- Ask from our seller for the telephone number of the Authorized Service in the area you are living in.

- At the completion of the process, the technician is obliged to write the 'Service Form' correctly and in detail and have you sign it and give a copy to you. Please keep the 'Service Form'.

- The items above have great importance for determining people who work under the name of special service and who are not Authorized Services. Please take note of these.

1.8. In case our Seller or our Authorized Service cannot satisfy your request or complaint please contact the communications means provided within the guide.

Sincerely yours,

## 2. General Characteristics of The Product

The highest quality polymethylacrylate, in other words, "Acrylic" is used as the primary material in the production of Vitra Acrylic Shower Trays. Acrylic which has a high wear resistance is preferred because it can be easily cleaned and does not host microorganisms.

Acrylic is known to be one of most accommodating materials for human nature. Having a flexible structure, acrylic maintains its resilience against impacts and does not deform. Any small scratches which might occur on the surface can easily be eliminated through polishing. Acrylic products do not lose their shine due to a homogenous distribution of color cells, and saves the "first day appearance" over years.

The acrylic plates used in the production of Acrylic Products are supplied from Lucite International (ICI) which is one of the leading producers of acrylic materials in the world and meets the EN 263 Standards for Acrylic Plates. The plates are assured against wear and tear. The usage life of the product is 10 years.

## 3. Matters Requiring Attention During Shipping, Transportation and Montage

3.1. The products must be protected against shocks during transport and storage. During storage and before assembly of the product, provide closed storage areas where the temperature will not drop below 15°C.

3.2. The packaged products must be protected against rain, water, humidity, dust and fire which can cause damage to the product and the packaging to cancel.

3.3. Do not pile products on top of each other or crush packaging on top of each other. Take precautions against spills and falls.

3.4. Wood, metal, mirrors or any of the products should not have puddles of water, if there are any they should be cleaned up immediately. The product should not be exposed to water directly or indirectly.

3.5. The products should be transported and placed according to the transportation and protection signs found on the package.

3.6. During the forklift carriage of products shipped in crates or cardboard packaging you should make use of pallets.

3.7. In order to prevent products from breaking during their storage and protection they should be placed in accordance with the direction indicated on the packaging and placing them on top of one another should be avoided.

3.8. Product parts removed from packages opened for the purpose of carrying to floors should be checked and carried in a protected manner.

3.9. Do not leave your products for a long time in buildings under construction.

3.10. During the delivery of products, external packaging should be checked for damage. If it is damaged, it should be indicated in the delivery note and notified to the relevant point of sale.

3.11. While designing the infrastructure prior to the installation, consider the technical specifications of the products and dimensions indicated.

1.12. The packaging of the product should be opened by Authorized Service during installation.

1.13. The installation should strictly be undertaken by the authorized service.

1.14. For the installation of the product, you should use the installation pack supplied with the product or the recommended auxiliary materials. Use our special screws and dowels for brick or concrete walls. Drill hole on the brick or concrete walls in the same diameter as dowel. Pile the plastic dowel in the same level as the wall and screw it by using special screw. For other wall types, installation parts can be supplied from specialized stores.

1.15. Materials that expand while freezing such as cement, plaster, etc. should not be used in installation.

1.16. The protective film layer on the product should not be removed before transportation, installation and repair procedures are completed. Product should not be removed before transportation, installation and repair procedures are completed.

## 4. Rules for Use, Maintenance and Repair

- If the construction activities in the bath will continue after installation, do not remove the folio layer on the product and apply full protection to the product.

### Possible Problems and Their Solutions

Problem	Solution
<ul style="list-style-type: none"><li>• The surface of the product is dull and/or scratched.</li></ul>	<ul style="list-style-type: none"><li>• If your product is new, the protective film layer on it might not have been removed.</li><li>• If dullness/scratches occur after a certain period of use, you may be using incorrect cleaning materials.</li></ul>
<ul style="list-style-type: none"><li>• My product stretches</li></ul>	<ul style="list-style-type: none"><li>• Check if the Wall hangers are installed on the wall or not. The wall hangers must be used in order to preserve the rigidity of the product.</li></ul>
<ul style="list-style-type: none"><li>• Water leakage under the product</li></ul>	<ul style="list-style-type: none"><li>• Check the silicone application between the product and the wall</li><li>• Check the isolation.</li></ul>
<ul style="list-style-type: none"><li>• The siphon drain of my product clogs frequently.</li></ul>	<ul style="list-style-type: none"><li>• Hair, soap, etc. could clog the siphon in time. Clean the siphon drain with a drain opener from time to time.</li></ul>
<ul style="list-style-type: none"><li>• The siphon plug does not open even though the control handle is forced.</li></ul>	<ul style="list-style-type: none"><li>• If you force the control handle too much the siphon wire could break. Therefore height adjustment should be made by turning the plug counter clock wise without forcing the handle.</li></ul>

If your problems persist please contact the nearest Authorized Service.

#### 4.1. Cleaning of Wooden Surfaces:

Cleaning cloth: Cotton-based damp cloth

Cleaning agent: Wipe with cotton-based, slightly damp cloth. Do not use any cleaning materials.

Cleaning method: Apply the damp cloth up and down on the surface without exerting too much pressure. Do not rub with exerting pressure. Then, the whole surface should be dried with a dry cloth.

#### 4.2. Cleaning of Acrylic, Steel and Metal-Covered Surfaces;

Cleaning cloth: Cotton-based damp cloth

Cleaning agent: Clean water, soapy water, non-scratching and non-solvent cleaning materials

Cleaning method: Apply the damp cloth up and down on the surface without exerting too much pressure.

Rinsing: Cleaning material on the surface should be removed with damp cloth and the whole surface should be dried with a dry cloth.

#### 4.3. Cleaning of Mirrors and Glass Surfaces;

Cleaning tool: They should be wiped with a damp, soft cloth.

Cleaning agent: Abrasive chemicals and ammonia-based, acidic or alkaline cleaning agents should not be used for cleaning the mirrors. Any cleaning agents should not be directly sprayed on the mirror's surface. Cleaning should not be performed using materials which could scratch the surface such as spatulas, etc. When patterned products are concerned, clean the glasses with a soft cloth and warm water.

Cleaning method: You should not attempt to remove ant strong stains while the glass is dry, the stains should be gently wiped with a cotton cloth dipped in clean hot water and squeezed well. Care should be given so that water does not collect on the lower edge of the mirror.

4.4. Products should not be cleaned with cleaners that are acidic and that contain abrasive dust (bleach, cleaners with ammoniac, hydrochloric acid etc). In case of contact, it should be thoroughly cleaned with water immediately

4.5. Products should be protected against impacts during handling and use.

4.6. The product should be protected against impacts caused by hard and sharp objects.

4.7. No cutting, drilling or painting process should be made on the products. The electrical parts in the product should not be intervened. All procedures related with the products should be performed by Vitra-Arteme Authorized Services.

4.8. It should be checked before and after use whether there is any water leakage caused by the installation or water accumulation on the furniture. If the water accumulation is not eliminated on time, the risk of swelling and inflating may occur. In this case, you should consult the Authorized Service that made the installation.

4.9. The hinges that enable the doors to move are designed only to bear the load of doors. Although they have a certain tolerance, additional loads exerted on the hinges may cause the hinges to lean out and may lead to functional problems.

4.10. During the cleaning of products, silicone material used for water insulation after the installation of the washbasin should be absolutely removed. If the silicone application was performed to impair the visual appearance, then notify the Authorized Service that made the installation to fix it.

4.11. The procedures to be performed with solvent materials such as paint, floor vanish etc may damage the metal enclosure of bathroom furniture. Therefore, the procedures to be made with such materials should be completed prior to the installation of bathroom furniture.

4.12. Do not leave wet laundry, damp cloths and materials used during cleaning (such as bucket, bowl etc.) on the wooden materials.

4.13. Steel surfaces are sensitive to impacts. Small scratches can be covered with steel paste. However, the grinding effect on the area where retouching procedure was applied will fade away.

4.14. Electrolysis coating method was applied on the handles. If cleaned with unsuitable cleaning materials, there is a risk of removal.

4.15. Do not place objects on furniture that have a high temperature degree and that might impair the surface.

4.16. Avoid contact of the product with high degree alcohol, naphtha, thinner, acetone etc.

4.17. Avoid any contact of the product with paint in the rays of the sun and ultraviolet which can yellow them / make lose their color

4.18. Products should not be used in the spaces that have insufficient ventilation and high moisture ratio (basement floor etc)

4.19. If the bathroom furniture will be installed next to the tub and shower tray, then shower enclosure should be fitted in between.

4.20. Ensure sufficient ventilation and drying after taking a bath or shower in bathroom. If the walls remain wet for long periods of time, fungus, mould stains or material damages may occur.

4.21. Against the risk of swelling, inflating, staining or corrosion, any of wood, metal, mirror and other parts of the products should not be exposed to water directly or indirectly, in case of this, the product should be wiped and cleaned immediately.

4.22. The connector that we provide for electrical connection is suitable for general-purpose connection types. Electrical connection applications may differ in your region or residential area. Connectors suitable for the network to which the product will be connected must be supplied and the connection must be carried out by specialists.

4.23. Keep lighted cigarettes away from the product.

4.24 Protect your product with a fuse. Keep the fuse closed when not using your massage system.

Description : Free Standing Bathtub

Size (cm)	:	190x90	180x80	170x80	160x75
Height (mm)	:	56,5	56,5	56,5	56,5
Depth (mm)	:	42	42	42	42
Weigth (kg)	:	45	43	38	36
Front Panel Weight (kg)	:	-	-	-	-
Side Panel Weight (kg)	:	-	-	-	-
Volume (lt)	:	355	300	283	250

Available Massage System : —



1

	190x90	180x80	170x80	160x75
<b>a</b>	1900	1800	1700	1600
<b>a1</b>	950	900	850	800
<b>a2</b>	1210	1110	1010	910
<b>a3</b>	1700	1600	1500	1400
<b>b</b>	900	800	800	750
<b>b1</b>	275	275	275	275
<b>b2</b>	520	420	420	370
<b>b3</b>	700	600	600	550

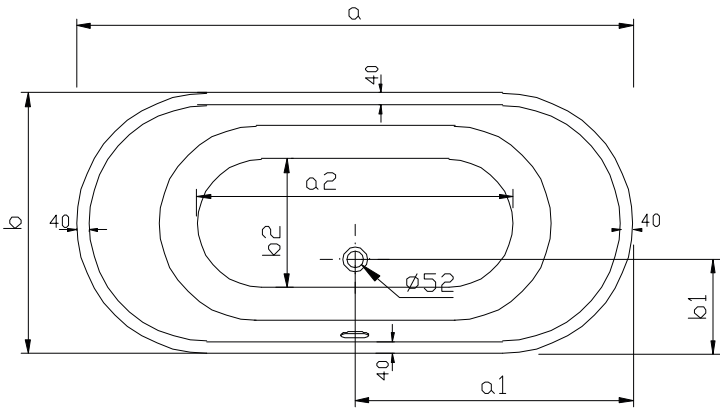

Plan

2

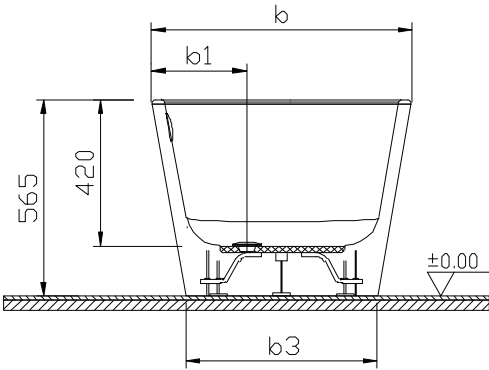
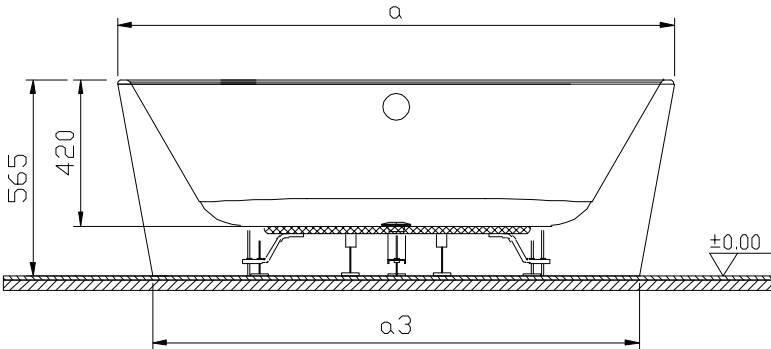

View

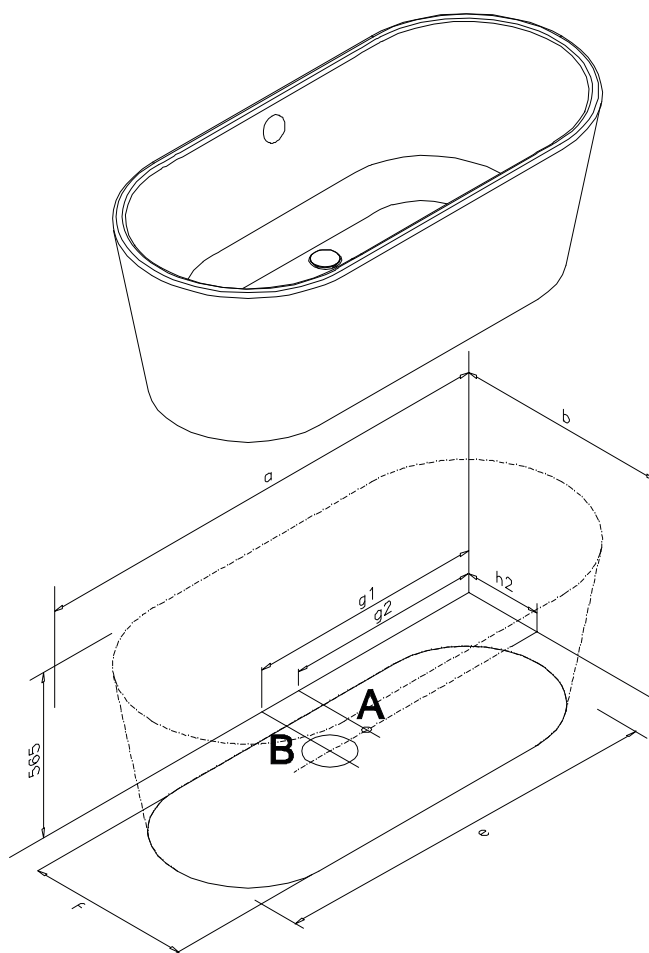

	190x90	180x80	170x80	160x75
<b>a</b>	1900	1800	1700	1600
<b>b</b>	900	800	800	750
<b>e</b>	1700	1600	1500	1400
<b>f</b>	700	600	600	550
<b>g1</b>	950	900	850	800
<b>g2</b>	850	800	750	700
<b>h2</b>	325	325	325	325

Perspective

GB

A : Ideal position of the waste outlet (Ø 50 mm). The end point of the waste outlet should not be cut out, and should be left at least 50 mm above the surface.

B : The area (Ø 200 mm) where the waste outlet should not be left.

D : Hot & cold water inlet for the taps on the bathtub.

There is no need to leave additional space for the silicone during the installation process. It is enough to prepare the required area according to the size of the product.

Description : Corner Bathtub

Size (cm)	: 180x80	165x75
Height (mm)	: 56,5	56,5
Depth (mm)	: 42	42
Weigth (kg)	: 42	38
Front Panel Weight (kg)	: -	-
Side Panel Weight (kg)	: -	-
Volume (lt)	: 238	210

Available Massage System : —



1

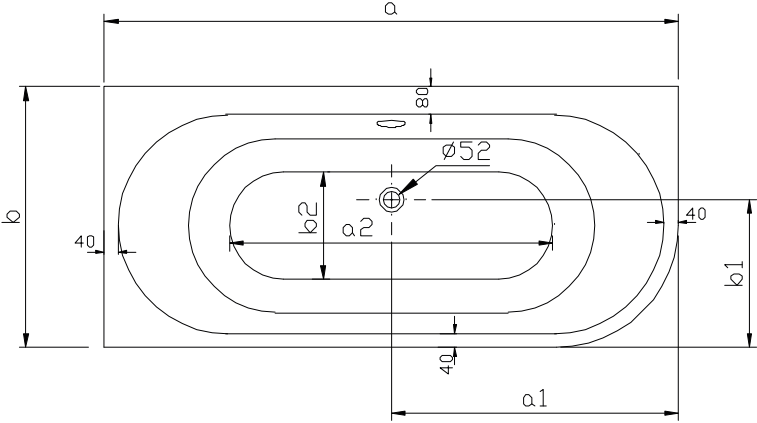

Plan



Detail A

The point (A) where the wall hangers will be placed shown in Figure Plan, the wall hangers are used to fix the product to the wall. It is suggested to use Them to rigid the product.

	180x80	165x75
<b>a</b>	1800	1650
<b>a1</b>	900	825
<b>a2</b>	1110	930
<b>a3</b>	1700	1550
<b>b</b>	800	750
<b>b1</b>	475	425
<b>b2</b>	360	310
<b>b3</b>	700	650

2

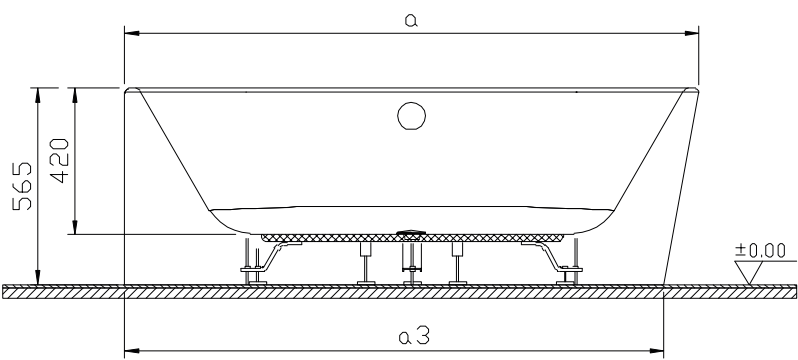

View

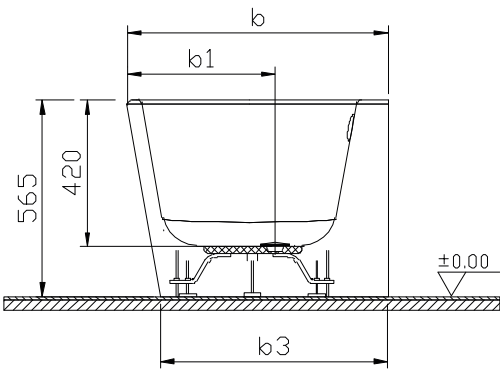



Description : *Back To Wall Bathtub*

Size (cm)	: 180x80	165x75
Height (mm)	: 56,5	56,5
Depth (mm)	: 42	42
Weigth (kg)	: 43	39
Front Panel Weight (kg)	: -	-
Side Panel Weight (kg)	: -	-
Volume (lt)	: 238	210

Available Massage System : —



1

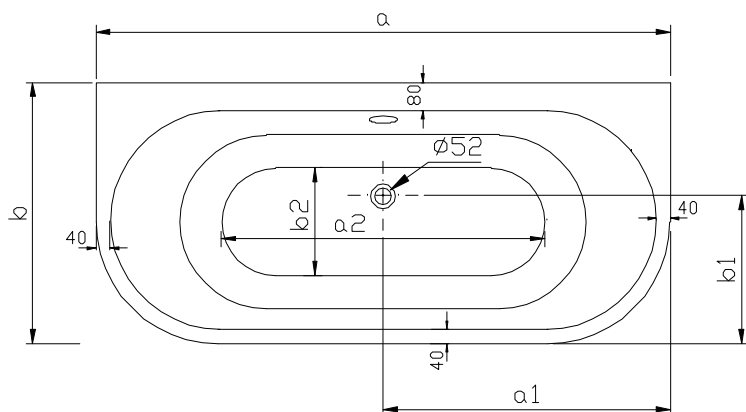

Plan



Detail A / Şekil A

The point (A) where the wall hangers will be placed shown in Figure Plan, the wall hangers are used to fix the product to the wall. It is suggested to use Them to rigid the product.

	180x80	165x75
<b>a</b>	1800	1650
<b>a1</b>	900	825
<b>a2</b>	1110	930
<b>a3</b>	1600	1450
<b>b</b>	800	750
<b>b1</b>	475	425
<b>b2</b>	360	310
<b>b3</b>	700	650

2

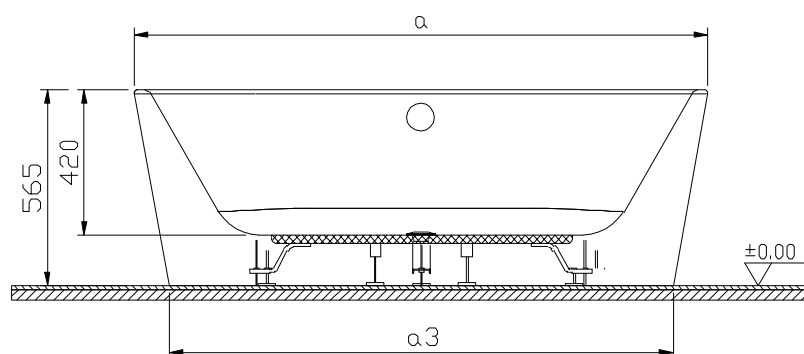

View

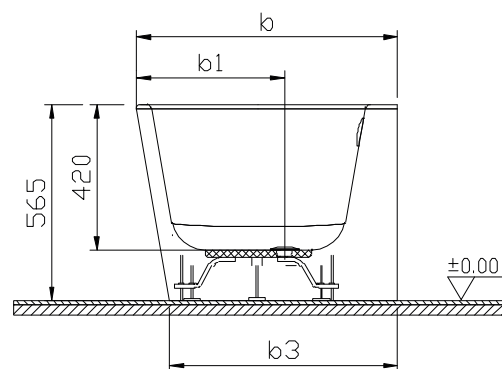

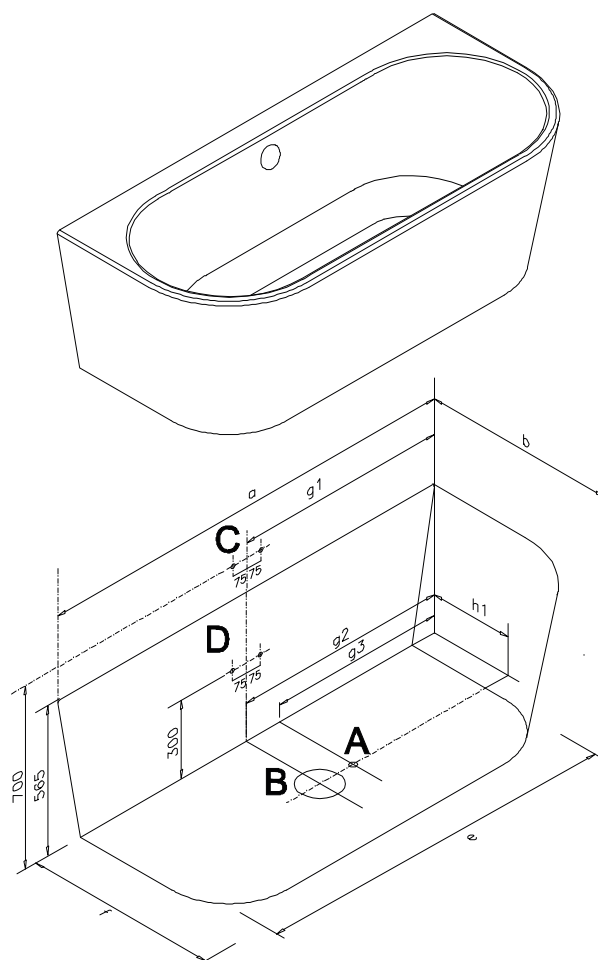

	180x80	165x75
<b>a</b>	1800	1650
<b>b</b>	800	750
<b>e</b>	1600	1450
<b>f</b>	700	650
<b>g1</b>	900	825
<b>g2</b>	900	825
<b>g3</b>	800	725
<b>h1</b>	400	375

Perspective

**GB**

A : Ideal position of the waste outlet ( $\varnothing$  50 mm). The end point of the waste outlet should not be cut out, and should be left at least 50 mm above the surface.

B : The area ( $\varnothing$  200 mm) where the waste outlet should not be left.

C : Hot & cold water inlet for the wall taps.

D : Hot & cold water inlet for the taps on the bathtub.

There is no need to leave additional space for the silicone during the installation process. It is enough to prepare the required area according to the size of the product.

## GB

Points to notice:

- The floor tiles should be even and the walls should be straight.
- An elbow and a waste connection hose of 50 mm will be delivered with the product but an edge lath and other accessories are not included.
- A ventilation and access window should be left if the hydromassage bathtub is installed without panels.
- During the installation of the panels, the adjustment of the leg set should be carried out according to the height of the panel.
- The faucet should not be applied on the pump of the hydromassage bathtub.
- The spout should be min 17 cm if the faucets are installed to the wall.
- Handgrip application for this product is available.
- For the cleaning of the acrylic bathtub look at the User Manual.
- Waste connection fuse, wall hangers and user manual are delivered with the product.

### Faucet Applications

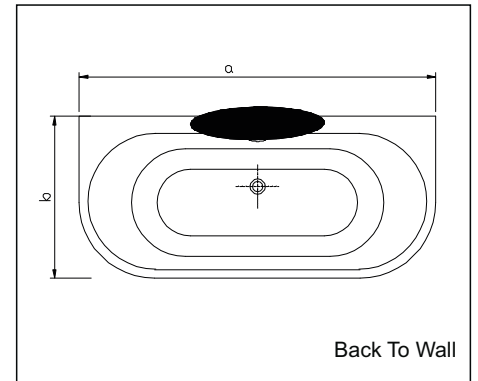
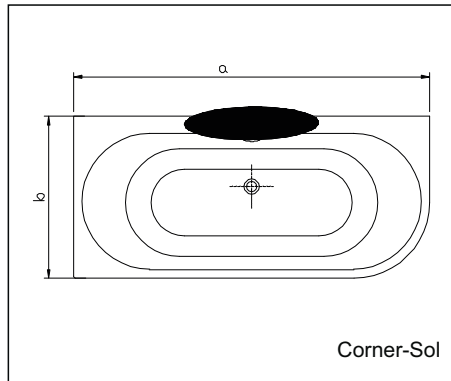
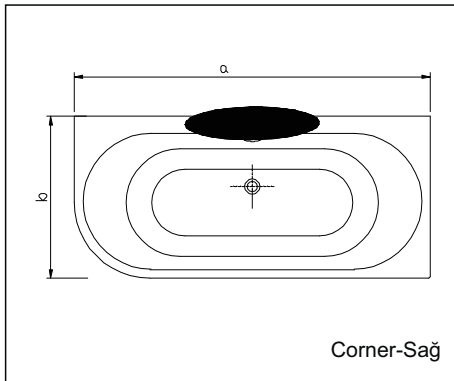

According to the faucet to be used, tap holes should be drilled in the area specified on the bathtub.

### Massage Systems

**ANY APPLICATION OF MASSAGE SYSTEM ON THESE BATHTUBS ARE NOT POSSIBLE.**

### Points that Require Attention before Installation:

- We recommend the bathtub to be installed after tiling the wall tiles and other construction related works in the bathroom are completed.
- The technical details of the bathtub is provided in the Technical Data Sheet.
- Faucets should be installed as shown on the Technical Data Sheet.
- If a wall-mounted bathtub mixer is preferred the appropriate mixer should be installed on the wall in accordance with the instructions provided in the Technical Data Sheet.
- It should be ensured that the floor tiles are even and the walls are straight (90 °) before starting installation.
- Cold and hot water connections must already be realized.

## Installation of FreeStanding Bathtubs

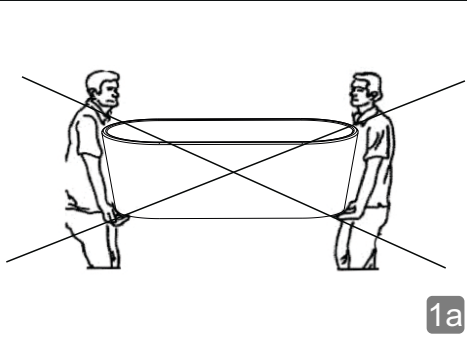
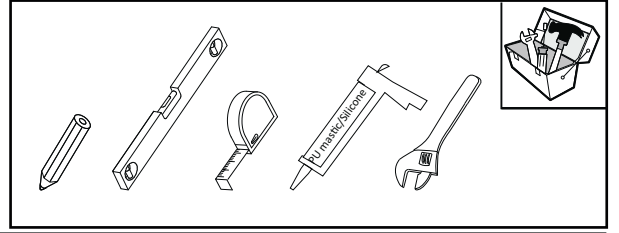
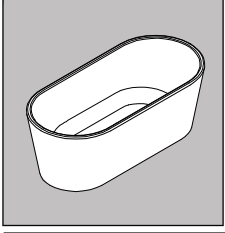

1a

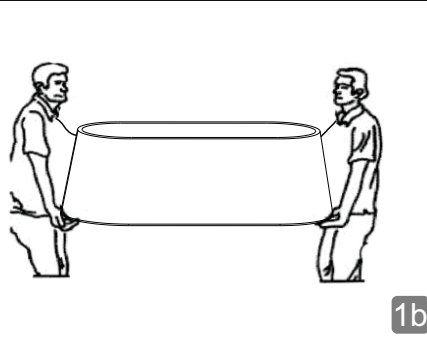

1b

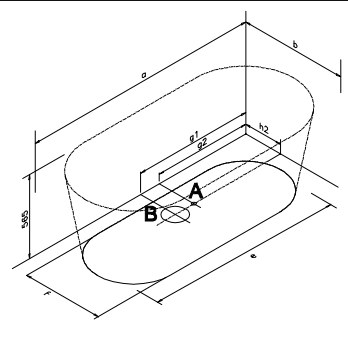

2

1- Carry the bathtub upside down. It must never be carried by holding from its panel.

2- The installation area must be ready. In this series a 'hidden overflow' is installed to plain by the manufacturer. Therefore the product comes with the siphon installed. The bathtub is placed on the installation area and the perimeter of its bottom is marked. Inside the marked area, the 50 mm diameter waste water drain pipe is installed from the center shown in the drawing, at the point indicated by the letter "A" as illustrated in the technical diagram. No water drain muff should be left in the area indicated by the letter "B". External faucet application should be carried with a min. distance of 100 mm to the bathtub and in accordance with the bathtub placement. The axle distance between the hot and cold water inlet pipes should be adjusted in accordance with the technical drawing of the faucet.

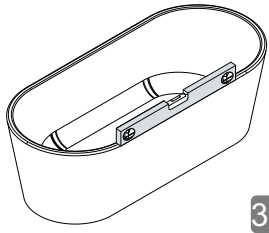

3a

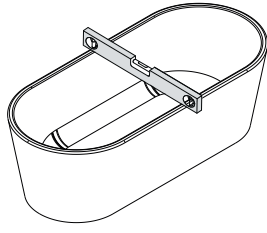

3b

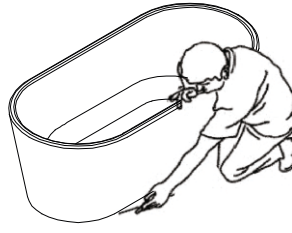

4

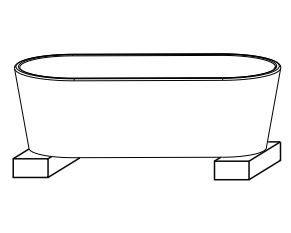

5

3- Take the bathtub into level using a scale at the installation area. **Caution: During the infrastructure installation, the bathtub should not be tilted sideways and no weight should be placed on its side panels.**

4- Draw the area of the bathtub with a pencil. Mark the parts of the bathtub's monobloc sides that touch the floor.

5- For the infrastructure installation, place the bathtub on bearing supports at the installation area



6

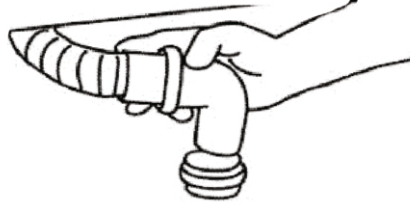

7

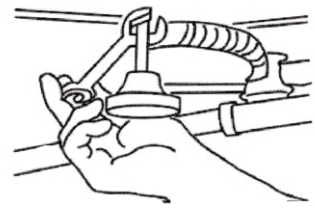

8

6- Pull the panel supporting brackets inside at the thickness of the acrylic and fix them to the floor with silicone. Accordingly, movement of the bathtub on the floor is prevented.

7- Make the siphon drain pipe connection.

8- Tighten the leg set nuts.

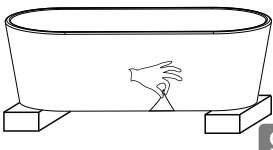

9

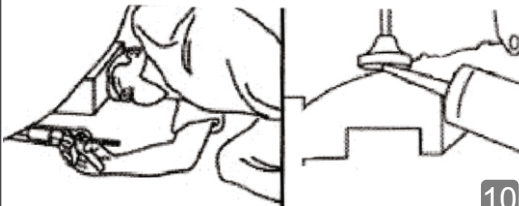

10

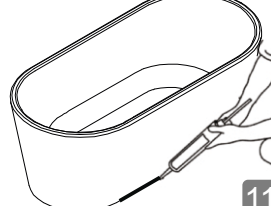

11

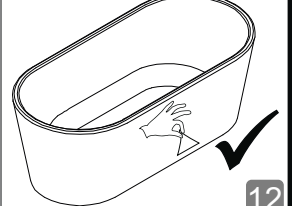

12

9- Peel off the protective folio of the bathtub from its sides that are touching the ground and from the area around the siphon. (Not all of it)

10- Apply silicone on the bathtub legs' parts which contact the floor.

11- Take down from the bearing supports. Apply silicone between the bathtub panel and the floor in order to prevent any leakage.

12- Remove the protective folio on the bathtub after the bathtub installation and any other construction works in the bathroom are finished.

## Installation of Corner and Back to Wall Bathtubs

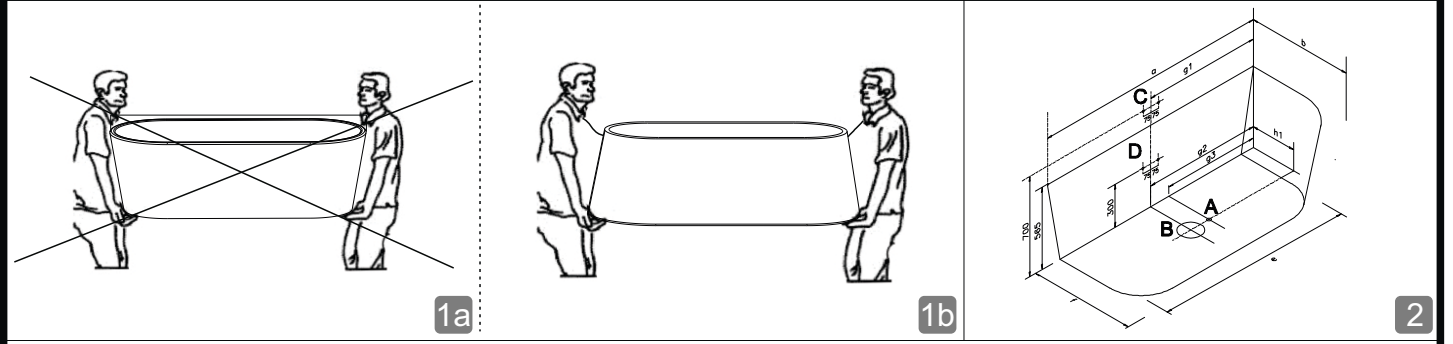
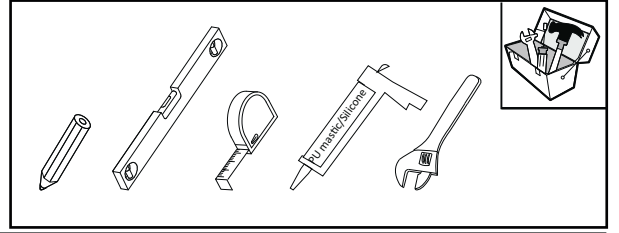
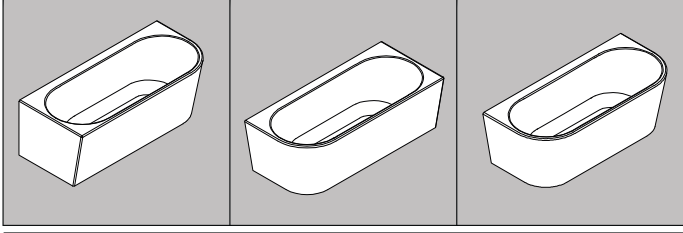

1- Carry the bathtub upside down. It must never be carried by holding from its panel.

2- The installation area must be ready. In this series a 'hidden overflow' is installed to plain by the manufacturer. Therefore the product comes with the siphon installed. The bathtub is placed on the installation area and the perimeter of its bottom is marked. Inside the marked area, the 50 mm diameter waste water drain pipe is installed from the center shown in the drawing, at the point indicated by the letter "A", and the inlet pipes are installed to the centerline of the faucet above the bathtub, at the point indicated by the letter "C" or "D", as illustrated in the technical drawing. No water drain muff should be left in the area indicated by the letter "B". The axle distance between the hot and cold water inlet pipes should be adjusted in accordance with the technical drawing of the faucet.

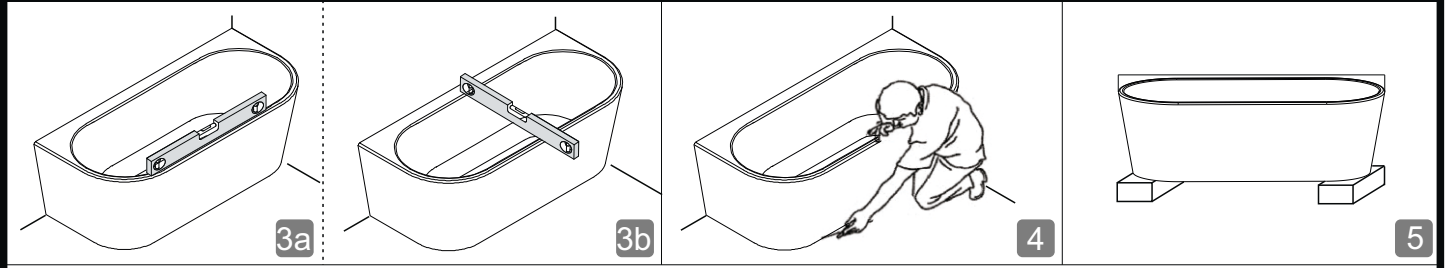

3- Take the bathtub into level using a scale at the installation area. **Caution: During the infrastructure installation, the bathtub should not be tilted sideways and no weight should be placed on its side panels.**

4- Draw the area of the bathtub with a pencil. Mark the parts of the bathtub's monobloc sides that touch the floor.

5- For the infrastructure installation, place the bathtub on bearing supports at the installation area

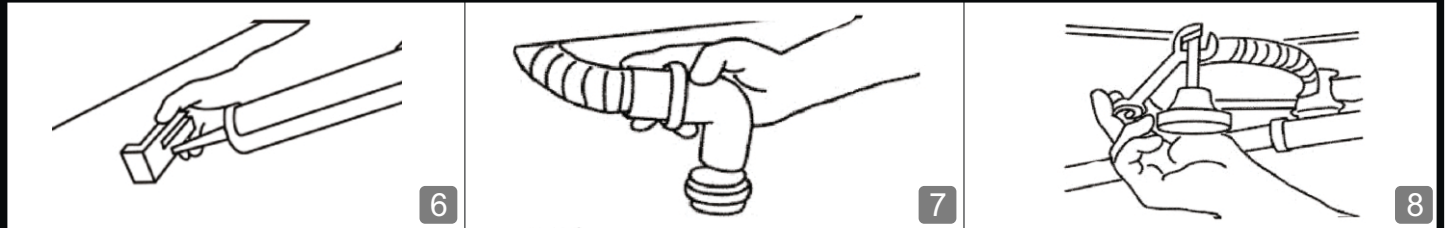

6- Pull the panel supporting brackets inside at the thickness of the acrylic and fix them to the floor with silicone. Accordingly, movement of the bathtub on the floor is prevented.

7- Make the siphon drain pipe connection.

8- Tighten the leg set nuts.

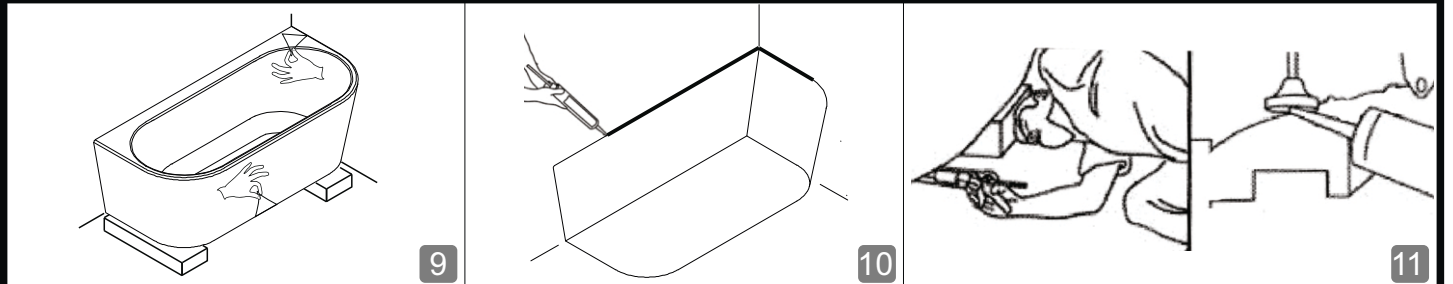

9- Peel off the protective folio of the bathtub from its sides that are touching the ground and the wall and from the area around the siphon. (Not all of it)

10- Apply silicone on the wall which contact the bathtub edge.

11- Apply silicone on the bathtub legs' parts which contact the floor. Take down from the bearing supports.

## Installation of Corner and Back to Wall Bathtubs

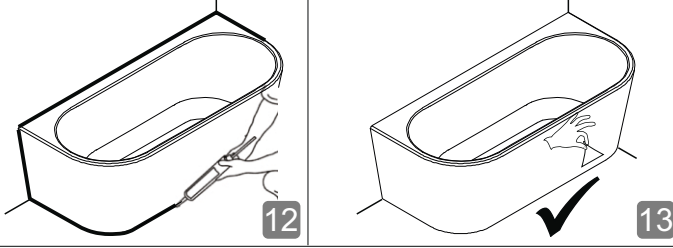

12- Apply silicone between the bathtub, the floor and the wall in order to prevent any leakage.

13- Remove all protective folio on the bathtub after the bathtub installation and any other construction works in the bathroom are finished.

### Conditions Outside Warranty Coverage

#### Shipping Storage

1. Deformations to the product surface during the shipping and transportation carried out after the products are delivered or any breakages which may occur as the result of impacts,
  2. Deformations and breakages on the surfaces of products which remain at the construction site for a long time without protection,
  3. Damage to the product as the result of effects of the water and/or humidity in the environment during the storage and use of the products,
  4. Products damaged by each other due to stacking on top of each other during storage,
- shall be treated out of scope of the warranty.

#### Installation

5. Failures which occur as the result of incorrect installation, maintenance, repairs and disassembly performed by unauthorized persons,
6. Defects caused by the failure to install or use the product in compliance with the technical catalogue, Installation or User's Guide
7. Factors which impact the installation of the product, resulting from hot-cold water, waste water outlet installements, or the wall or floor not being level,
8. Failure to use the auxiliary materials accompanying the product, or recommended auxiliary materials in installation
9. Defects that are visible in the delivery/assembly despite the written confirmation and for which the orderer does not reserve the rights arising from this document.
10. Surface deformations and failures occurring due to small particles in the plumbing (stone, sand, gravel, etc.) and encrustation,
11. Failures where cutting and drilling procedures not made by Authorized Service

#### Use, Cleaning and Maintenance

12. Deformations and failures on the surface, electronic parts due to practices other than the use functions specified in the User Guide
  13. Deformations and dullness occurring on the surface of products wiped with cleaning substances containing acid and cleaning substances containing abrasive powders,
  14. Deformations and dullness occurring on the surface of products wiped with rough cleaning substances (wire sponge, hardened sponge, etc.),
  15. Pattern degradation due to the patterned glasses of the cabins being cleaned by a cleaning agent other than water.
  16. Deformations that welding electrode sparks, flammable substances during alterations made in the bathroom spaces and cigarettes may cause on the product surface,
  17. Failures occurring due to use of parts other than original spare parts,
  18. Defects caused by lighting materials (Rays of the Sun, LED, fluorescent, spot etc.)
  19. Damages in electronics due to voltage change,
  20. Damages that may occur due to insufficient ventilation of the environment and leaving the product damp and wet.
  21. Failures to declare the approved document or invoice showing that the product is within the warranty period,
  22. Damages and failures that may occur as a result of using the product in a manner that does not comply with "Considerations During Installation" and "Rules for Use, Maintenance and Repair"
  23. Disassembling and disposal of disassembled products, excluding warranty internal failures, are the responsibility of our customers.
  24. The disassembled products should be evaluated within the framework of the EXCAVATION SOIL, CONSTRUCTION AND WASTES CONTROL REGULATION, and the district municipality should be contacted for disposal.
- shall be treated out of scope of the warranty.

**pianura**

Sanitary Brands Group GmbH  
Heisenbergstr. 19a  
50169 Kerpen  
Germany

[www.sanitarybrands.group/bvo.html](http://www.sanitarybrands.group/bvo.html)

DOP PN-BW1-EN14516-2013-1  
EN 14516 CL1  
CA-DA  
Personal hygiene (PH)

\* The Producer. always keep the right to make any technical changes on the product without prior notice.