

White Tulip # WT 4995 L/R

Montageanleitung

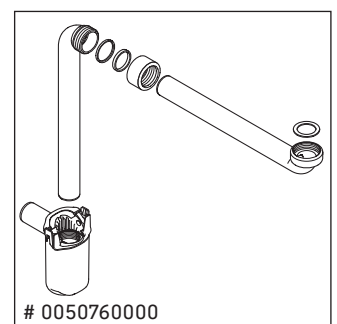
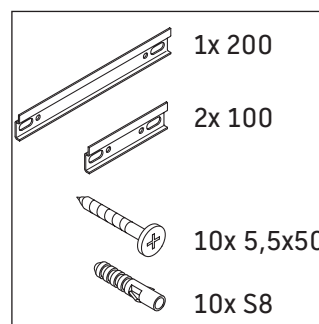
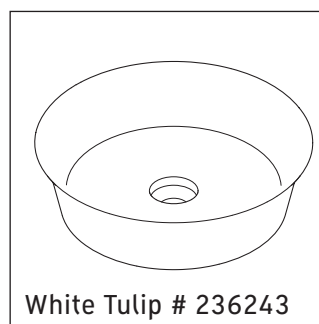
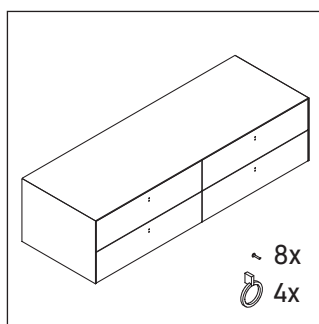
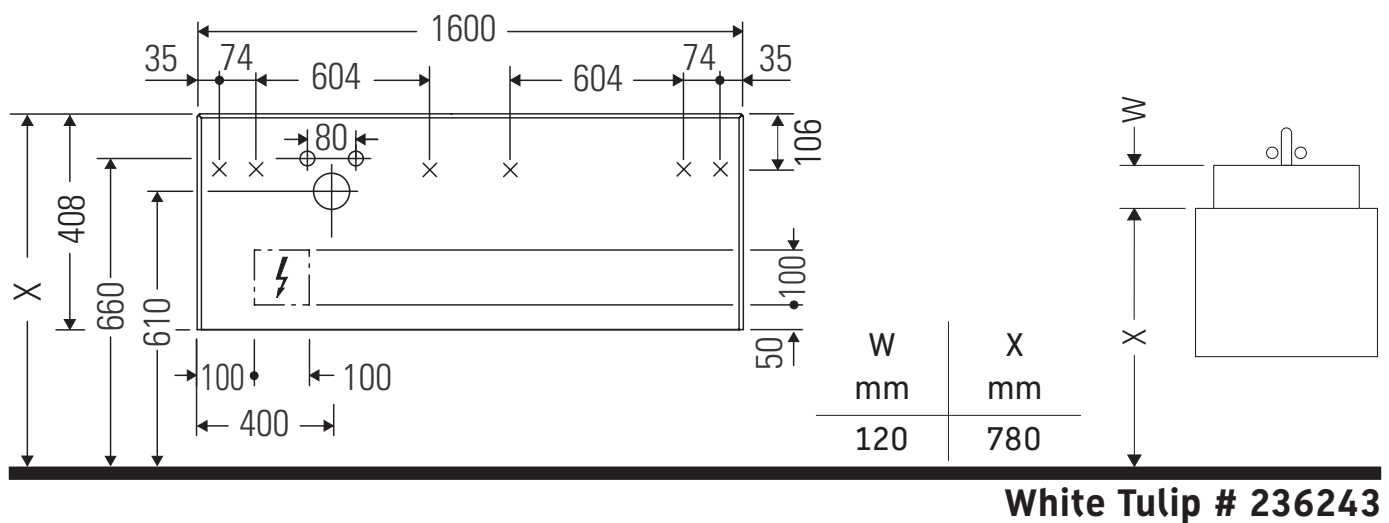

Verwendungshinweise

Die Badmöbelserie entspricht den gültigen Normen und Richtlinien zum Zeitpunkt der Auslieferung und ist für den Einsatz in Bädern konzipiert. Eine direkte Benetzung mit Wasser z. B. beim Duschen ist zu vermeiden.

Technische Verbesserungen und optische Veränderungen an den abgebildeten Produkten behalten wir uns vor.

Technical drawing of a rectangular plate with the following dimensions and features:

- Overall width: 1600
- Overall height: 408
- Top edge features: Two vertical slots, each 74 wide, separated by 604. The distance from the left edge to the first slot is 35, and from the second slot to the right edge is 35.
- Bottom edge features: Two vertical slots, each 100 wide, separated by 100. The distance from the left edge to the first slot is 100, and from the second slot to the right edge is 50.
- Internal features: A lightning bolt symbol is located in the lower-left quadrant. There are also two 'x' marks on the top edge, one in each of the 604 wide sections.
- Right edge features: A vertical slot 106 wide, centered vertically.

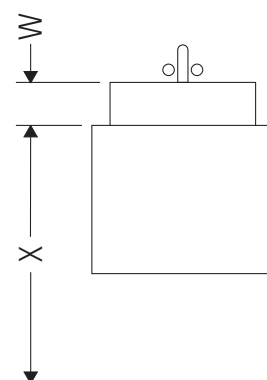

Isometric drawing of the assembled sideboard. Dimensions are indicated: 8x (height) and 4x (width of the lower section). Hardware callouts include a screw icon and a ring icon.

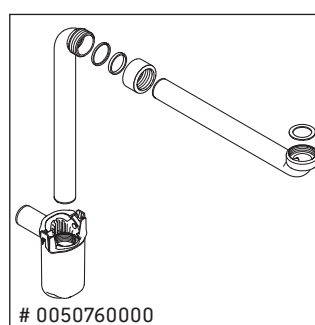
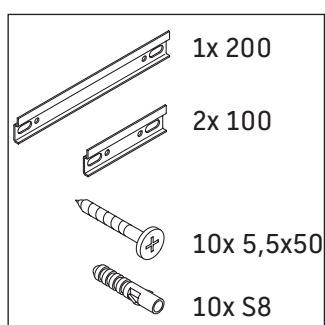

MAL_White Tulip_WT4995/22.03.1

